

## User Manual

# Safeaccess & NAV2

DOC210-EN-26.03.11



# Table of contents

1. Certification .....	3
2. Preliminary checks .....	4
3. Use of the system .....	6
3.1. Number of users .....	6
3.2. Procedure .....	6
3.3. Tilting end stop .....	6
4. Deformation in case of fall .....	6
5. Fall Clearance .....	7
5.1. Fall clearance Ceiling/ wall + lanyard .....	7
5.2. Fall clearance Ceiling/ wall + retractable lanyard .....	8
6. Prohibited use .....	9
7. Warnings .....	9
8. Maintenance and inspection .....	9
9. Marking .....	10

# 1. Certification

The Horizontal track system Safeaccess Rail and NAV 2 trolley have been designed and tested according to the European standard and british standards:

EN795-D:2012  
BS8610:2017

The system conforms to the American National regulation,

OSHA 1910

If the system is designed and installed by a competent person (according to OSHA), it may conform to the ANSI standard,

ANSI/ASSE Z359.6: 2009  
CSA Z259.16-15

The certifications which can be downloaded anytime from our web portal: <https://assistant.fallprotec.com>

<b>Standard</b>	EN 795-D :2012	
<b>Certificate Number</b>	N°17.6.0238	
<b>Certification Date</b>	01/08/2017	
<b>Notified body</b>	<b>Code</b>	0082
	<b>Address</b>	Apave Sudeurope, Centre d'essais et certification EPI, 17, Boulevard Paul Langevin, 38600Fontaine, France

<b>Standard</b>	ATEX Directive 94/9/EC (Explosive environnements)	
<b>Certificate Number</b>	N°TÜV IT 11 ATEX 026 X	
<b>Certification Date</b>	20/06/2011	
<b>Notified body</b>	<b>Code</b>	-
	<b>Address</b>	TÜV Italia, Via Carducci 125, Pal. 23, 20099, Sesto San Giovanni, Italia

<b>Standard</b>	BS 8610 :2017	
<b>Certificate Number</b>	N°RQC2021-072/A	
<b>Certification Date</b>	20/06/2011	
<b>Notified body</b>	<b>Code</b>	-
	<b>Address</b>	Quintin Certifications, 825 route de Romans, 38160, Saint Antoine France

## 2. Preliminary checks

It is mandatory to check the following before using the system :

USER	✓ The user of the lifeline must be in good physical condition, and not prone to vertigo or dizziness.
	✓ The user must have received adequate training for the following: <ul style="list-style-type: none"> <li>• Personal protection equipment and have read the user instructions of the elements associated to the system, the harness, and the connectors/carabiners.</li> <li>• Use of the fall protection equipment,</li> <li>• Use of the rescue equipment in the event of fall.</li> </ul>
	✓ The total mass of each user, including tools and equipment, must not exceed 150 kg.
	✓ A minimum of <b>2 persons</b> are required to work nearby, so that each can assist the other in the event of an incident.
PPE	✓ A suitable harness with two anchoring points or D rings, one at the back and one at the chest, in conformity with the EN 361 or ANSI / ASSEZ359.1.
	✓ The dorsal anchorage point is the recommended point to anchor the harness, the sternal anchorage point can be used for rescue operations,
	✓ An energy absorber lanyard in conformity with EN 354/355 or ANSI/ASSEZ359.13. It cannot be longer than 2m (6.5ft),
	✓ Two karabiners twist lock type in zinc plated steel, according to EN 362 ANSI/ASSEZ359.12 and having the following characteristics, length 105 mm, width 58 mm, wire diameter 10 mm, opening 20 mm, breaking strength 23 kN
SYSTEM	✓ Check if the annual inspection was carried out within less than 1 year.
	✓ There is no obstacle under the walkway that could reduce the fall clearance ;
	✓ If there are tilting end stops, they must be tested and must work properly ;
	✓ There are no deformed components.
	✓ A <b>rescue plan</b> must be in place to evacuate the person who fell within 15 minutes. The rescue material must be easily accessible and be in the vicinity from the lifeline.
	✓ The system must be immediately put out of service if the user notices one or more anomalies and the failing components must be replaced by a certified installer (Also competent person if under OSHA regulations)
Any other combination of components can affect the correct functioning of the system and is consequently forbidden.	

Before using the system, the user must locate the ID-plate installed in the immediate vicinity of the access point and follow the instructions on the board. The plate has a QR code that facilitates access to the Fallprotec web portal where all the data regarding the installation is registered. User manual and inspection log.

Manufactured by

**FALLPROTEC** ①

FALLPROTEC SA  
T: +352 26 55 09 30  
F: +352 26 55 09 30 55  
www.fallprotec.com

②



Installed by

**FALLPROTEC**

Height Safety Products

**DUMMY DEALER COMPANY** ④

this is where the address comes

Some Town

Luxembourg

+991 (4) 7480842

www.businessname.online

SecuRope 2012 horizontal/inclined ③

EN795-C:2012  
TS16415:2013



Project name  
Project Name 1 ⑤  
Company  
Besix 2  
Installation date  
2018-06-15 ⑥  
Length  
77 m ⑦

Serial #  
2019-11-5 ⑧  
Location  
Brucity B ⑨  
Number of users  
1 x max. 100 kg ⑩  
Fall clearance  
15 ⑪



⑫

⑬

⑭



⑮

II 2G Ex IIB T6 Gb  
II 2D Ex IIB T85°C Db

-20°C < Tamb < +75°C

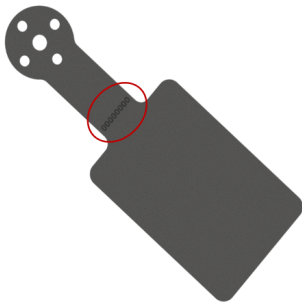

A unique serial number is marked on the warning plate.

1. Manufacturer's information
2. QR code to get direct access to the information related to the installation.
3. Equipment type and applied standards.
4. Installer details
5. Information about the project and client
6. Installation Date
7. System length
8. Seal tag serial number.
9. System location
10. Maximum number of users and their max. weight.
11. Fall clearance.
12. It is mandatory to use a fall arrest harness with an energy absorbing system according to EN355 and EN360.
13. It is mandatory to read the user manual first.
14. Inspection sticker

### 3. Use of the system

#### 3.1. Number of users

Maximum number of users between 2 brackets (For other cases please contact Fallprotec)	4
---	---

**⚠** The trolley is designed and tested to allow users weighting 140 kg. (If a special marking is required, please contact Fallprotec).

#### 3.2. Procedure

The connection and disconnection to the system must always be carried out in an area without any risk of a fall.	
1	Connect the mobile anchor device to the Lifeline: if the mobile anchorage device is openable, it can be introduced at any point of the system.
2	If the system contains tilting end stops, the user will tilt it to connect the mobile anchor device on the system and it will close automatically.
3	The user moves smoothly all along the lifeline without running.
4	The carabiner of the lanyard must be fixed directly to the mobile anchor device.
5	To exit from the system (if the device is not openable), the user must remove it the end of the line by means of activating a tilting end stop. (If the glider is openable and/ or reachable, it should be stored in a dry place)

#### 3.3. Tilting end stop

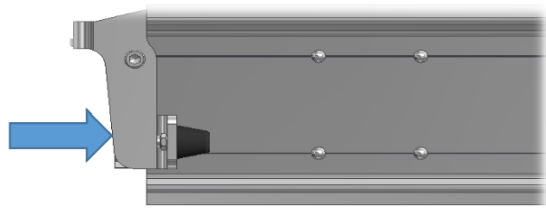

Closed position

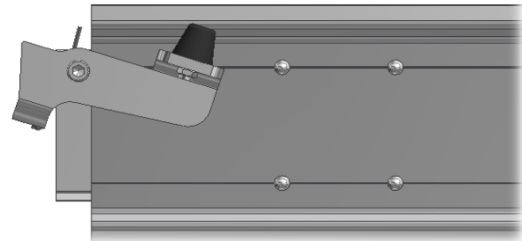

Open position

### 4. Deformation in case of fall

Maximum deflection with junction at 500 mm from the fixing bracket	30 mm (1.18")
Maximum deflection with junction at 3m from the fixing bracket	200 mm (7.87")

## 5. Fall Clearance

### 5.1. Fall clearance Ceiling/ wall + lanyard

The installation must be performed so that in case of a fall occurring, there is no contact with any sharp edges or something that could cause damage of or to the equipment.

**⚠** The minimum clearance must be higher to the height of the fall to prevent the falling user from hitting any obstacles during the occurring fall.

1. Fall clearance<sub>Required</sub> : minimal height calculated and required in case of a fall
2. Fall clearance<sub>Available</sub> : actual available height between the path and the first obstacle
3. D<sub>Deflection</sub> : the deflection of the anchor line
4. L<sub>Lanyard</sub> : length of the lanyard (< 2m, 6 feet for U.S.)
5. L<sub>Absorber</sub> : deployment of the energy absorption system (< 1.5m)
6. H<sub>User</sub> : user's height
7. H<sub>Line</sub> : Height of the anchor line
8. H<sub>Safety</sub> : safety distance (1m)

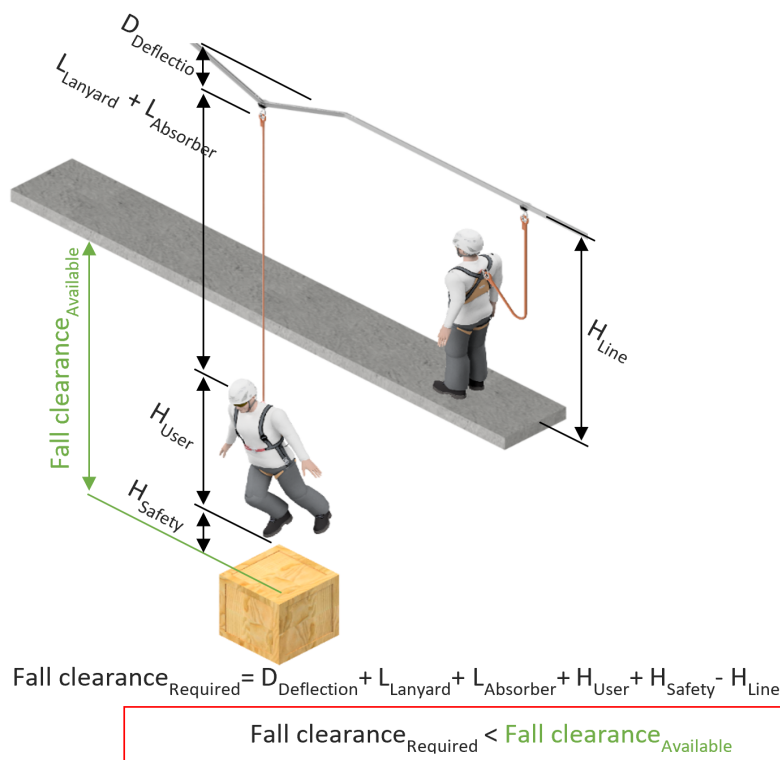

## 5.2. Fall clearance Ceiling/ wall + retractable lanyard







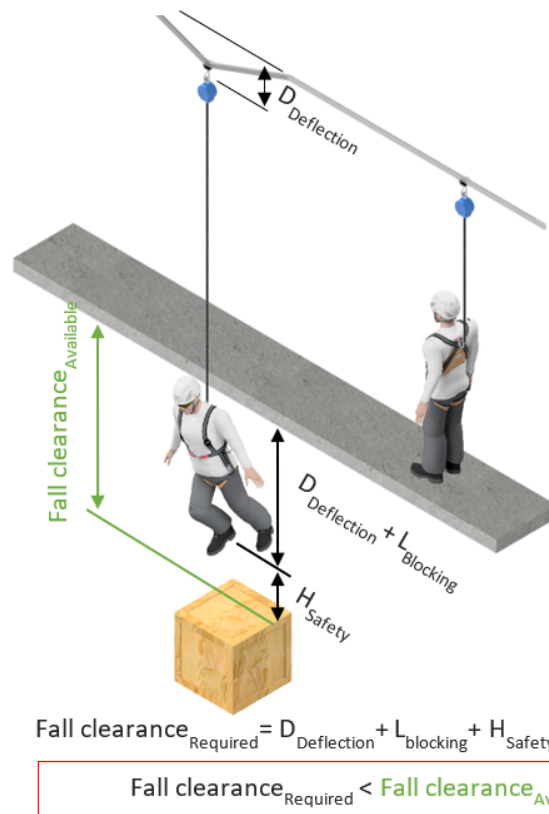

The installation must be done so that in case of a fall the equipment is not in contact with a sharp edge or any object that can damage it (See user manual of retractable lanyard for more information).

 The minimum clearance must be higher to the height of the fall to prevent the falling user from hitting any obstacles during the occurring fall.



1. Fall clearance<sub>Required</sub> : minimal height calculated and required in case of a fall
2. Fall clearance<sub>Available</sub> : actual available height between the path and the first obstacle
3.  $D_{\text{Deflection}}$  : the deflection of the anchor line
4.  $L_{\text{blocking}}$  : length of blocking of retractable lanyard (including energy absorber)
5.  $H_{\text{User}}$  : user's height
6.  $H_{\text{Safety}}$  : safety distance (1m)



## 6. Prohibited use

-  It is forbidden to use the system out of the limits specified in this manual or in any other situation different for the ones the system has been foreseen.
-  Exceed the maximum number of users between on the system.
-  It is forbidden to use the system with any other element, for which the system was commissioned for.
-  It is forbidden to use the system under the walkway.
-  It is forbidden to use the system for lifting materials.
-  In case of storm or any other exceptional climate conditions potentially dangerous.
-  Temperature below -50°C.
-  It is forbidden to use the system as earth phase for welding.

## 7. Warnings

-  Marking of the equipment must be always visible.
-  Any modification of the system or equipment cannot be made without prior written authorization of FALLPROTEC.

## 8. Maintenance and inspection

- Each system must be inspected annually or after a fall.
- The inspection must be carried out by a certified/authorized installer (Also competent person if under OSHA regulations).
- The inspection must be registered on the Fallprotec portal <https://assistant.fallprotec.com>.
- The safety of the user is linked to the maintenance of the efficacy of the system and the resistance of the equipment.
- Mobile anchor devices are stored in a dry place.
- If the anchorage device is used in a dusty environment, mobile anchor devices need to be cleaned with soapy water. The lifeline is cleaned with soapy water or solvent if the environment is not flammable.
- The durability is function of the maintenance of the system and the frequency (and intensity) of use. It will also depend on the host structure and its capacity to keep its physical properties during the time.

## 9. Marking

The equipment is marked as follows :

1. Manufacturer :
2. Component name :
3. Standard : EN795-D / TS161415 / OSHA 1910
4. It is mandatory to read the user manual before use &
5. Manufacturing batch (Quarter/Year)
6. Capacity

